

NSU AC10 Surface Lot Pass

4th District Court of Appeal, Oral
Argument--General Public

Wednesday, April 4, 2018



NOVA SOUTHEASTERN
UNIVERSITY

7:00 AM – 5:30 PM

Event Surface Lot – AC10

**DISPLAY THIS PASS ON THE DASHBOARD
OF YOUR CAR WHEN YOU PARK**

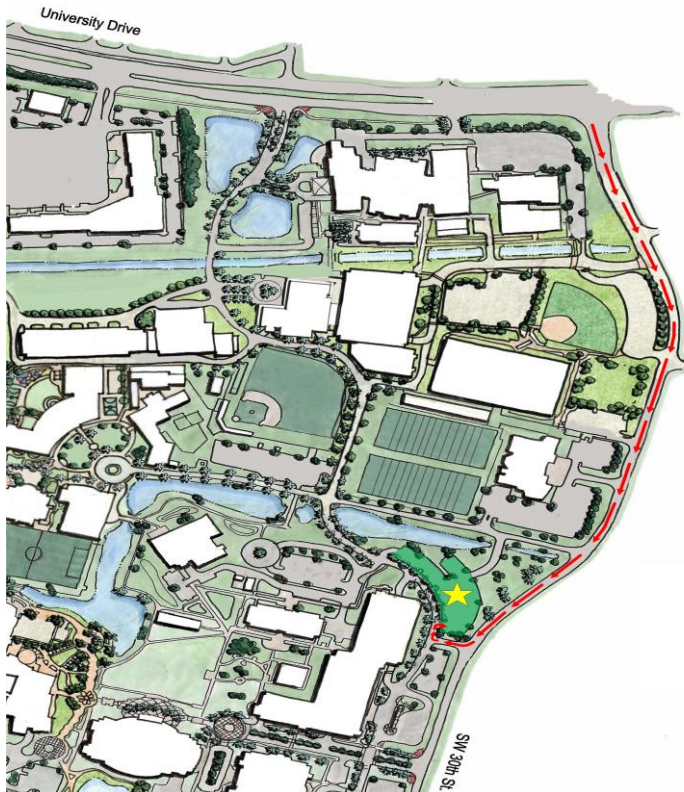

Directions to the Parking area:

From I-95, north or south, or Florida's Turnpike, north or south, take I-595 exit, westbound.

Proceed on I-595 to University Drive; turn left and proceed southbound on University Drive to SW 30th Street.

Turn left onto SW 30th Street and proceed approximately 1/2 mile NSU Northwest.

Entrance (next entrance after 75th Ave) and turn right. At the stop sign, you will have **AC10** lot to the right. The Arm Gates will be in the up position.

This pass will not be honored in any other area except as specified above. Parking in the metered section (1st floor) of the public garage costs \$1.00 per hour even with this pass displayed.